

FPL RULMAN YATAKLARI / BEARING INSERT

M PA PP

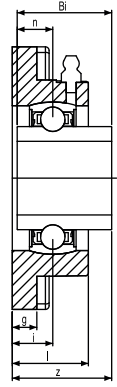
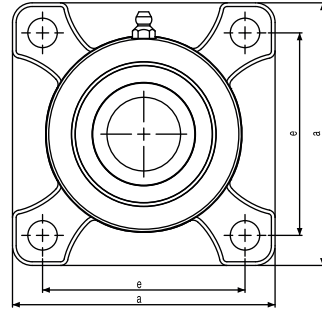
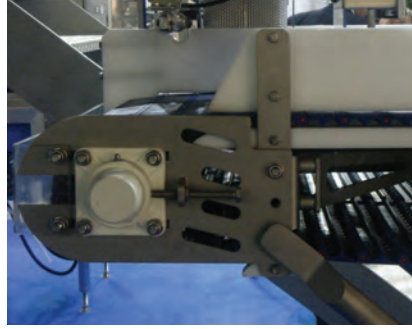

M	Ölçüler/Dimension (mm)											Metrik Bolt D. (mm)	Kg		Stok Kod Stock Code (Metal Rulmanlı Yatak)	Kg		Stok Kod Stock Code (Rulmansız Yatak)	Stok Kod Stock Code (Paslanmaz Rulmanlı Yatak)	Yük Kapasitesi Bearing Load Ratings		
	øEJE	a	e	g	l	s	z	i	Bi	n	dyn (N)									st (N)		
PA	ø20	87	63,5	13,4	27	11	36,3	18	31	12,7	M10	0,29	+	245 FPL 204	0,13	-	246 FPL 204	247 FPL 204	7800	5300	50	
	ø25	95	69	14,5	27	11	36,7	17	34	14,3	M10	0,36	+	245 FPL 205	0,17	-	246 FPL 205	247 FPL 205	8600	6250	40	
PA	ø30	107	82,5	15	31	11	41,4	19,2	38,1	15,9	M10	0,50	+	245 FPL 206	0,20	-	246 FPL 206	247 FPL 206	12000	9000	30	
	ø35	118	92	19	34	11	46,9	21,5	42,9	17,5	M12	0,74	+	245 FPL 207	0,26	-	246 FPL 207	247 FPL 207	15700	12000	20	
	ø40	130	102	19	36	13	53,2	23	49,2	19	M12	0,97	+	245 FPL 208	0,35	-	246 FPL 208	247 FPL 208	17900	14300	15	

NFL RULMAN YATAKLARI / BEARING INSERT

M PA PP

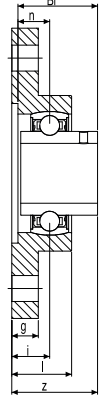
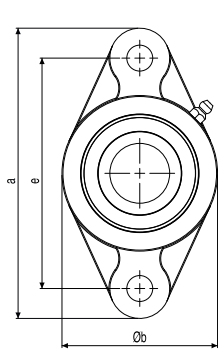

M	Ölçüler/Dimension (mm)											Metrik Bolt D. (mm)	Kg		Stok Kod Stock Code (Metal Rulmanlı Yatak)	Kg		Stok Kod Stock Code (Rulmansız Yatak)	Stok Kod Stock Code (Paslanmaz Rulmanlı Yatak)	Yük Kapasitesi Bearing Load Ratings		
	øEJE	a	e	b	g	l	s	z	i	Bi	n									dyn (N)	st (N)	
PA	ø20	116	89,5	65	11,4	26,5	11	33,7	15,4	31	12,7	M10	0,24	+	245 NFL 204	0,08	-	246 NFL 204	247 NFL 204	7800	5300	50
	ø25	130	98	69	13,5	29,1	11	36,7	17	34	14,3	M10	0,30	+	245 NFL 205	0,11	-	246 NFL 205	247 NFL 205	8600	6250	40
PA	ø30	147	115,5	79	13,3	30,5	11	41,2	19	38,1	15,9	M10	0,45	+	245 NFL 206	0,15	-	246 NFL 206	247 NFL 206	12000	9000	30
	ø35	163	129	89	16,1	32,8	13	43,4	18	42,9	17,5	M12	0,66	+	245 NFL 207	0,18	-	246 NFL 207	247 NFL 207	15700	12000	20
	ø40	175,5	143	98	20	37,5	14	51,7	21,5	49,2	19	M12	0,87	+	245 NFL 208	0,25	-	246 NFL 208	247 NFL 208	17900	14300	15