

946- 12,7 MM. HASIR BANT

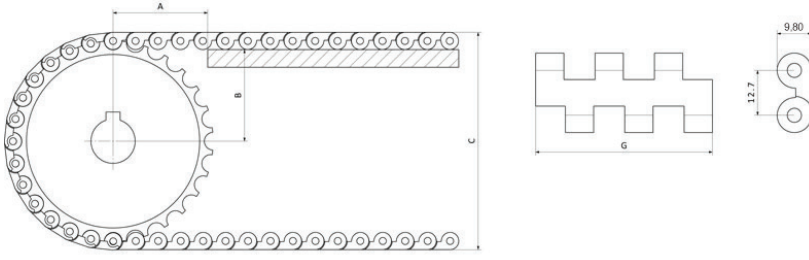

Hatve	12,7 mm
Bant Kalınlığı	9,80 mm
Açıklık Oranı (%)	Kapalı yüzey (%0)
Bakla Geniřliđi	254,4mm / 100mm / 50mm
Geniřlik ölçülendirme	16-17mm
Renk	Beyaz - Mavi - Gri (standart malzeme için)
Temizlenebilirlik	Orta (FDA gıdaya uygunluk)
PIM Çapı	4mm
Diř üstü yarı çap	Diřli boyutuna göre deđişmektedir

AKSESUARLAR

949- 12,7 HASIR TAřIMA BANT GÖTÜRÜCÜ BANT

DIřLİ

388 HASIR BANT DIřLİSİ

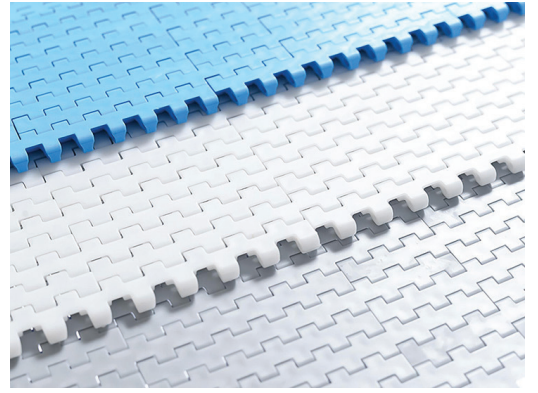
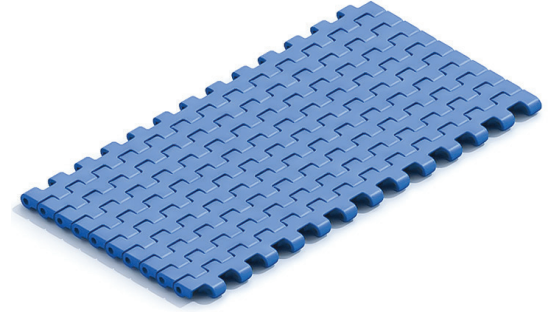

Stok Kod (Stock Code)	P	RM	Malzeme/Material	L	PIN	Bant Dayanımı Chain Strength (N/m)	Kg / m ²	
946 M01 K01	12,7	-	Polipropilen Polypropylene	254,4	PP	10000	4,5	m
946 M02 K01	12,7	-	Poliasetal Polyacetal	254,4	PA	15000	8,5	m

HASIR BANT STANDART MALZEME

Malzeme	Stok Kod	Stok Kod
Polipropilen (PP)	+1	+110
Poliasetal (POM)	-40	+90
Polietilen (PE)	-60	+100

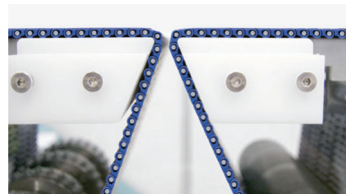
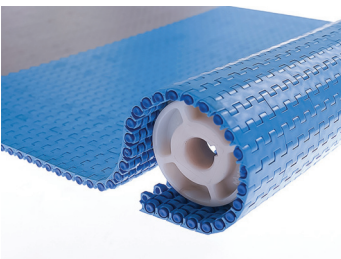
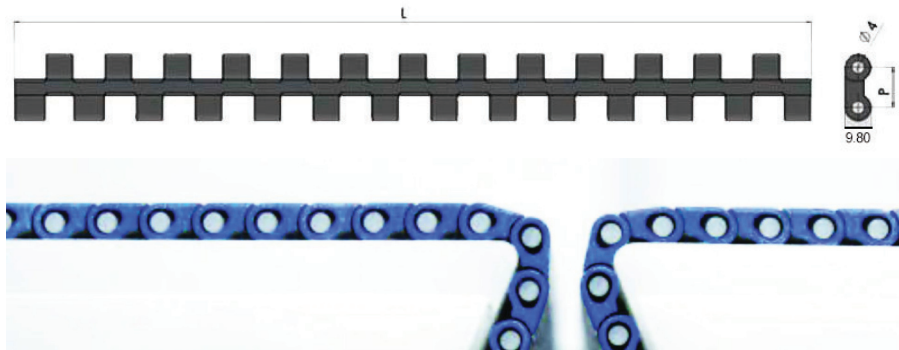

949- 12,7 HASIR TAŞIMA BANT GÖTÜRÜCÜ BANT

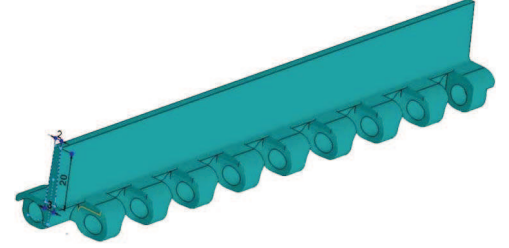
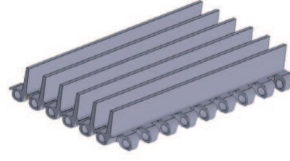
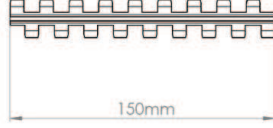
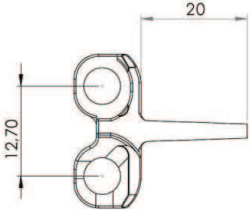

Stok Kod [Stock Code]	P	Renk [Color]	L	H	Malzeme/Material	PIN	Kg/m2	
949 B01 K01	12,7	Beyaz/White (B)	150	20	Polipropilen Polypropylene	PP	10,400	m
949 B02 K01	12,7	Beyaz/White (B)	150	20	Poliasetal Polyacetal	PA	10,400	m
949 M01 K01	12,7	Mavi/Blue (M)	150	20	Polipropilen Polypropylene	PP	15,120	m
949 M02 K01	12,7	Mavi/Blue (M)	150	20	Poliasetal Polyacetal	PA	15,120	m
949 G01 K01	12,7	Gri/Gray (G)	150	20	Polipropilen Polypropylene	PP	15,120	m
949 G02 K01	12,7	Gri/Gray (G)	150	20	Poliasetal Polyacetal	PA	15,120	m

Hatve	12,7 mm
Bant Kalınlığı	9,80 mm
Açıklık Oranı (%)	Kapalı yüzey (%0)
Bakla Geniřliđi	254,4 mm /100mm/ 50mm
Geniřlik ölçüleme	mm
Renk	Beyaz - Mavi - Gri (standart malzeme için)
Temizlenebilirlik	Orta (FDA gıdaya uygunluk)
PIM Çapı	4mm
Götürücü	Yükseklik : 20 mm
Yan boşluk uygulaması	Özel boşluklu ölçülere tabidir

Standart Yan Boşluk Ölçüleri	mm	inch
Standart kesimli olarak	33,30	1,31
Standart kesimsiz olarak	50,00	1,97
Standart kesimli olarak	66,66	2,62
Standart kesimli olarak	83,33	3,28
Standart kesimsiz olarak	100,00	3,94

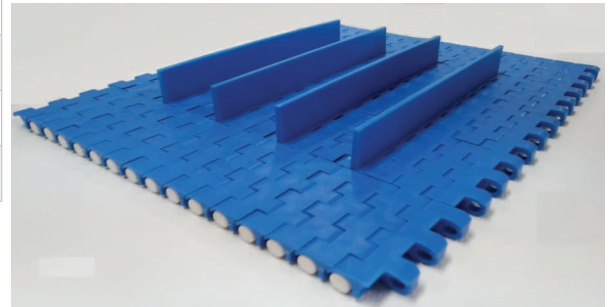

388 HASIR BANT DİŞLİSİ

 BANT : 945 - 946

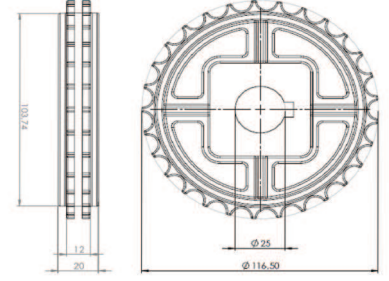
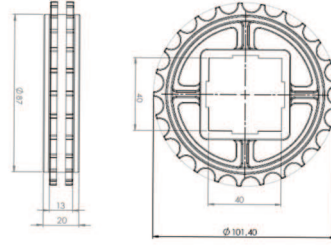

STN Stok Kod [Stock Code]	DF	DE	DP	Kalınlık Thicknes	Z-İmalat Şekli [Manufacture]	Kg
388 D25 T24	ø25	97,20	87,20	20	24-Kalıplı/Molding	0,2
388 D30 T24	ø30	97,20	87,20	20	24-Kalıplı/Molding	0,2
388 D35 T24	ø35	97,20	87,20	20	24-Talaşlı/Sawdust	0,2
388 D40 T24	40x40	97,20	87,20	20	24-Kalıplı/Molding	0,2
388 D25 T25	ø25	101,40	91,40	20	25-Kalıplı/Molding	0,25
388 D30 T25	ø30	101,40	91,40	20	25-Kalıplı/Molding	0,25
388 D35 T25	ø35	101,40	91,40	20	25-Talaşlı/Sawdust	0,25
388 D40 T25	40x40	101,40	91,40	20	25-Kalıplı/Molding	0,25
388 D25 T29	ø25	117,50	107,50	20	29-Kalıplı/Molding	0,3
388 D30 T29	ø30	117,50	107,50	20	29-Kalıplı/Molding	0,3
388 D35 T29	ø35	117,50	107,50	20	29-Talaşlı/Sawdust	0,3
388 D40 T29	40x40	117,50	107,50	20	29-Kalıplı/Molding	0,3
388 D25 T38	ø25	153,70	143,70	20	38-Kalıplı/Molding	0,35
388 D30 T38	ø30	153,70	143,70	20	38-Kalıplı/Molding	0,35
388 D35 T38	ø35	153,70	143,70	20	38-Talaşlı/Sawdust	0,35
388 D40 T38	40x40	153,70	143,70	20	38-Kalıplı/Molding	0,35

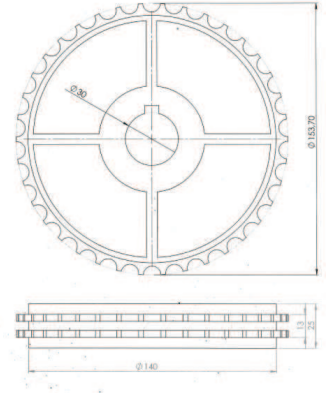
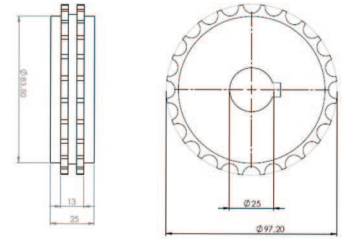

12.7 HASIRBAND DİŞLİ Z.38
Göbek; Ø25mm Ø30mm 40.40 kare



388.Grup Görseli B / Z38 / Z24 / Z29 / Z25

